

IAS Series

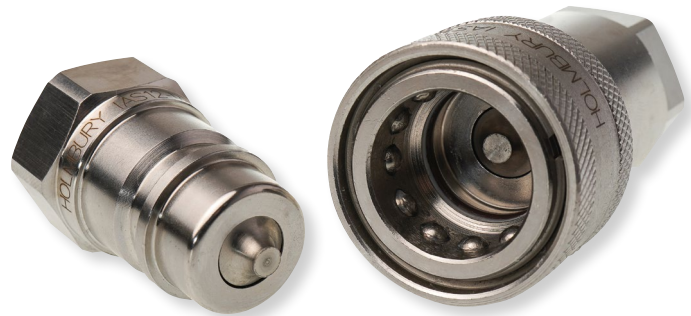

INTRODUCTION

Holmbury's IAS Series stainless steel ISO A couplings incorporate all the benefits of the carbon steel IA Series couplings, whilst being perfectly suited for corrosive fluids and environments.

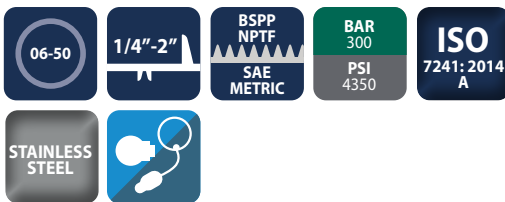

CONSTRUCTION

- AISI 316 stainless steel
- Fitted with FKM seals (Other seals available on request)
- Also available in carbon steel (See IA Series)

FEATURES

- Poppet valves have balanced springs
- Locking ball system allows for quick connection
- Bidirectional flow

ACCESSORIES

- Dust caps, plugs and seal kits are available for the IAS Series

SPECIFICATIONS

- Operating temperatures (With FKM seals): -20°C (-4°F) to 200°C (392°F)

APPLICATIONS

- Corrosive fluids and environments
- Marine
- Offshore/onshore
- Chemical
- Pharmaceutical

IAS PERFORMANCE CHARACTERISTICS

Body Size	IAS06	IAS10	IAS12	IAS19	IAS25	IAS32	IAS40	IAS50
	Pressure in bar - Flow in LPM							
Pressure in PSI - Flow in GPM								
Maximum working pressure (Coupled)	300	250	250	250	200	140	140	90
	4350	3625	3625	3625	2900	2030	2030	1305
Burst pressure (Coupled)	900	750	750	750	600	420	420	270
	13050	10880	10880	10880	8700	6090	6090	3925
Burst pressure (Male)	950	820	820	820	650	450	470	300
	13780	11895	11895	11895	9430	6530	6815	4350
Burst pressure (Female)	900	750	750	750	600	420	420	270
	13055	10880	10880	10880	8700	6090	6090	3915
Rated flow	3	23	45	106	189	288	379	757
	0.8	6.1	12	28	50	76	100	200

CAPS/PLUGS ACCESSORIES

FEMALE PLUGS	MALE CAPS
IA06-F-PLUG	IA06-M-CAP
IA10-F-PLUG	IA10-M-CAP
IA12-F-PLUG	IA12-M-CAP
IA19-F-PLUG	IA19-M-CAP
IA25-F-PLUG	IA25-M-CAP

Standard colour is red pvc, other colours available upon request



ISO A couplings made to the ISO 7241:2014 Series A Standard

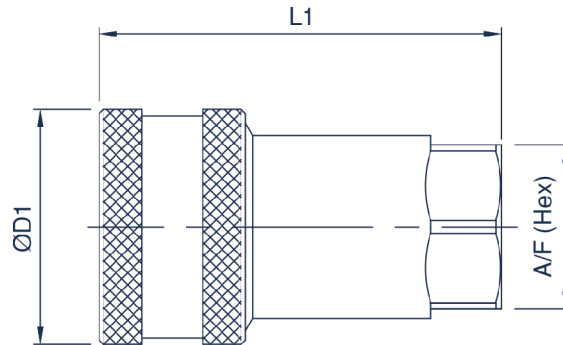

IAS FEMALE COUPLING

Body Size	Part Number	Thread Size	D1		L1		A/F	
			mm	inch	mm	inch	mm	inch
06 (1/4)	IAS06-F-04G	1/4 BSPP	26.0	1.02	50.0	1.79	19.0	0.75
	IAS06-F-04N	1/4 NPTF	26.0	1.02	50.0	1.79	19.0	0.75
	IAS06-F-04S	7/16-20 UNF	26.0	1.02	50.0	1.79	19.0	0.75
10 (3/8)	IAS10-F-06G	3/8 BSPP	31.5	1.24	56.0	2.21	22.0	0.87
	IAS10-F-06N	3/8 NPTF	31.5	1.24	56.0	2.21	22.0	0.87
	IAS10-F-06S	9/16-18 UNF	31.5	1.24	56.0	2.21	22.0	0.87
12 (1/2)	IAS12-F-08G	1/2 BSPP	38.6	1.52	66.3	2.61	27.0	1.06
	IAS12-F-08N	1/2 NPTF	38.6	1.52	66.3	2.61	27.0	1.06
	IAS12-F-08S	3/4-16 UNF	38.6	1.52	66.3	2.61	27.0	1.06
	IAS12-F-10S	7/8-14 UNF	38.6	1.52	66.3	2.61	27.0	1.06
	IAS12-F-12N	3/4 NPTF	38.6	1.52	66.3	2.61	32.0	1.26
19 (3/4)	IAS19-F-12G	3/4 BSPP	48.0	1.89	80.2	3.16	34.0	1.34
	IAS19-F-12N	3/4 NPTF	48.0	1.89	80.2	3.16	34.0	1.34
	IAS19-F-12S	1 1/16-12 UN	48.0	1.89	80.2	3.16	34.0	1.34
25 (1)	IAS25-F-16G	1 BSPP	56.0	2.20	94.2	3.71	41.0	1.61
	IAS25-F-16N	1 NPTF	56.0	2.20	94.2	3.71	41.0	1.61
	IAS25-F-16S	1 5/16-12 UN	56.0	2.20	94.2	3.71	41.0	1.61
32 (1 1/4)	IAS32-F-20G	1 1/4 BSPP	69.4	2.73	117.1	4.61	50.0	1.97
	IAS32-F-20N	1 1/4 NPTF	69.4	2.73	117.1	4.61	50.0	1.97
40 (1 1/2)	IAS40-F-24G	1 1/2 BSPP	84.0	3.31	133.0	5.24	60.0	2.36
	IAS40-F-24N	1 1/2 NPTF	84.0	3.31	133.0	5.24	60.0	2.36
50 (2)	IAS50-F-32G	2 BSPP	99.0	3.90	165.0	6.50	75.0	2.95
	IAS50-F-32N	2 NPTF	99.0	3.90	165.0	6.50	75.0	2.95

SEAL KITS

- IAS06-F-SEAL KIT
- IAS10-F-SEAL KIT
- IAS12-F-SEAL KIT
- IAS19-F-SEAL KIT
- IAS25-F-SEAL KIT
- IAS32-F-SEAL KIT
- IAS40-F-SEAL KIT
- IAS50-F-SEAL KIT

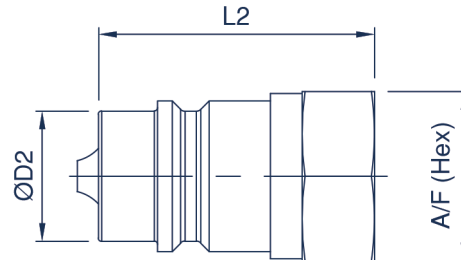

IAS MALE COUPLING

Body Size	Part Number	Thread Size	D2		L2		A/F	
			mm	inch	mm	inch	mm	inch
06 (1/4)	IAS06-M-04G	1/4 BSPP	11.8	0.46	35.5	1.40	19.0	0.75
	IAS06-M-04N	1/4 NPTF	11.8	0.46	35.5	1.40	19.0	0.75
	IAS06-M-04S	7/16-20 UNF	11.8	0.46	35.5	1.40	19.0	0.75
10 (3/8)	IAS10-M-06G	3/8 BSPP	17.3	0.68	36.5	1.44	22.0	0.87
	IAS10-M-06N	3/8 NPTF	17.3	0.68	36.5	1.44	22.0	0.87
	IAS10-M-06S	9/16-18 UNF	17.3	0.68	36.5	1.44	22.0	0.87
12 (1/2)	IAS12-M-08G	1/2 BSPP	20.5	0.81	43.5	1.71	27.0	1.06
	IAS12-M-08N	1/2 NPTF	20.5	0.81	43.5	1.71	27.0	1.06
	IAS12-M-08S	3/4-16 UNF	20.5	0.81	43.5	1.71	27.0	1.06
	IAS12-M-10S	7/8-14 UNF	20.5	0.81	43.5	1.71	27.0	1.06
	IAS12-M-12N	3/4 NPTF	20.5	0.81	43.5	1.71	27.0	1.06
19 (3/4)	IAS19-M-12G	3/4 BSPP	29.1	1.14	57.0	2.24	35.0	1.38
	IAS19-M-12N	3/4 NPTF	29.1	1.14	57.0	2.24	35.0	1.38
	IAS19-M-12S	1 1/16-12 UN	29.1	1.14	57.0	2.24	35.0	1.38
25 (1)	IAS25-M-16G	1 BSPP	34.3	1.35	59.5	2.34	41.0	1.61
	IAS25-M-16N	1 NPTF	34.3	1.35	59.5	2.34	41.0	1.61
	IAS25-M-16S	1 5/16-12 UN	34.3	1.35	59.5	2.34	41.0	1.61
32 (1 1/4)	IAS32-M-20G	1 1/4 BSPP	45.0	1.77	75.0	2.95	50.0	1.97
	IAS32-M-20N	1 1/4 NPTF	45.0	1.77	75.0	2.95	50.0	1.97
40 (1 1/2)	IAS40-M-24G	1 1/2 BSPP	55.0	2.16	83.5	3.29	60.0	2.36
	IAS40-M-24N	1 1/2 NPTF	55.0	2.16	83.5	3.29	60.0	2.36
50 (2)	IAS50-M-32G	2 BSPP	65.1	2.56	105.0	4.13	75.0	2.95
	IAS50-M-32N	2 NPTF	65.1	2.56	105.0	4.13	75.0	2.95

For all other configurations or thread types please contact the sales office.