



Connect under pressure ISO A couplings made to the ISO 7241:2014 Series A standard

IAPC Series



INTRODUCTION

Holmbury's IAPC Series ISO A couplings incorporate a pressure relief mechanism that enable them to be connected under pressure by hand.



CONSTRUCTION

- Female half available in either a 'Pull Break' or 'Push Pull' design (See drawing for differentiation)
- Carbon steel with trivalent plating
- Fitted with Nitrile seals

FEATURES

- Connects with up to 250 bar (3675 psi) residual pressure (If both male and female are IAPC couplings)
- Poppet valves have balanced springs
- Locking ball system allows quick connection
- Bidirectional flow

ACCESSORIES

- Dust caps and plugs are available for the IAPC Series

SPECIFICATIONS

- Operating temperatures (with Nitrile seals): -40°C (-40°F) to 106°C (223°F)

APPLICATIONS

- Agricultural
- Mobile
- Construction
- General hydraulics

IAPC PERFORMANCE CHARACTERISTICS

Body Size	IAPC12 (PP)	IAPC12 (PB)
	Pressure in bar - Flow in LPM Pressure in PSI - Flow in GPM	
Maximum working pressure (Coupled)	320 4640	320 4640
Burst pressure (Coupled)	1500 21750	1500 21750
Burst pressure (Male)	1500 21750	1500 21750
Burst pressure (Female)	1400 20300	1400 20300
Rated flow	45	45
	12	12

CAPS/PLUGS ACCESSORIES

FEMALE PLUGS	MALE CAPS
IA12-F-PLUG	IA12-M-CAP

Standard colour is red pvc, other colours available upon request

For IAPC performance characteristics see IA12-M (page 42).

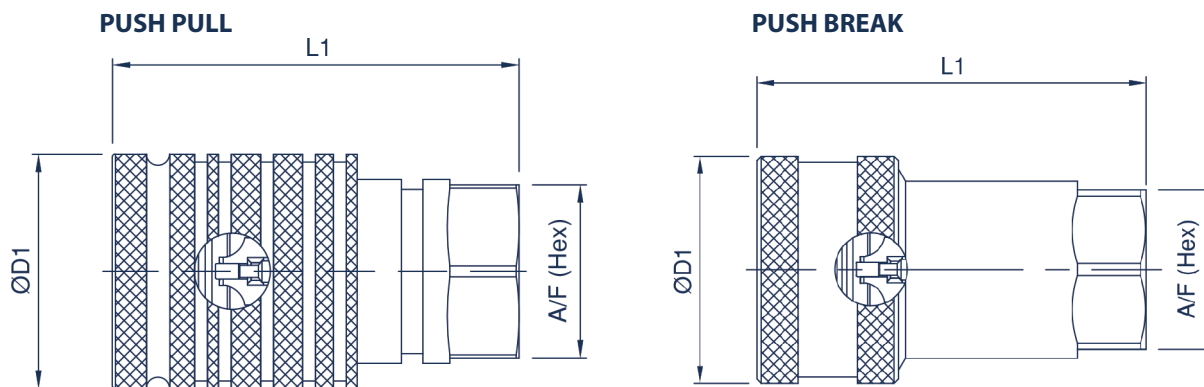

IAPC FEMALE COUPLING

Body Size	Part Number	Thread Size	D1		L1		A/F	
			mm	inch	mm	inch	mm	inch
12 (1/2)	IAPC12-F-08G	1/2 BSPP	38.0	1.50	66.5	2.62	27.0	1.06
	IAPC12-F-08N	1/2 NPTF	38.0	1.50	66.5	2.62	27.0	1.06
	IAPC12-F-08S	3/4-16 UNF	38.0	1.50	66.5	2.62	27.0	1.06

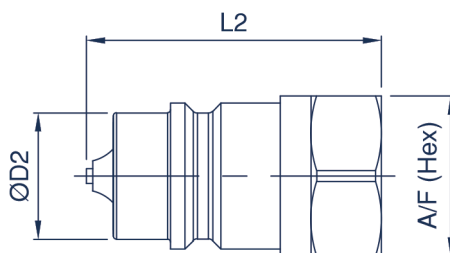

IAPC MALE COUPLING

Body Size	Part Number	Thread Size	D2		L2		A/F	
			mm	inch	mm	inch	mm	inch
12 (1/2)	IAPC12-M-08G	1/2 BSPP	20.52	0.81	43.5	1.71	27.0	1.06
	IAPC12-M-08N	1/2 NPTF	20.52	0.81	43.5	1.71	27.0	1.06
	IAPC12-M-08S	3/4-16 UNF	20.52	0.81	43.5	1.71	27.0	1.06

For all other configurations or thread types please contact the sales office.