



90° flat face couplings made to the ISO 16028 Standard

H90/HQ90 Series



INTRODUCTION

Holmbury's H90 and HQ90 Series is designed for use in applications that require a 90° elbow in the hydraulic circuit, such as digger booms. The right angle design allows for easy mounting without the need for additional fittings, reducing potential leakage paths and cost.



CONSTRUCTION

- Carbon steel with zinc nickel plating (1200 hours with no red rust in salt spray tests)
- Fitted with NBR seals

FEATURES

- The H90 and HQ90 Series is designed to connect with the HQ and HCP Series flat face couplings
- 90° elbow incorporated into the coupling
- The HQ90 benefits from a reduced size back end, allowing installation into tighter spaces
- Flat faces are easily wiped clean
- Allows for minimal inclusion of air and contaminants during connection
- Flat face design prevents fluid loss during disconnection
- Bidirectional flow

ACCESSORIES

- Dust caps are available for the H90 and HQ90 Series

SPECIFICATIONS

- Operating temperatures (With NBR seals): -40°C (-40°F) to 106°C (223°F)

APPLICATIONS

- Leak free environments
- Construction attachments
- Mobile equipment
- General industrial
- Agricultural
- Skid steer loaders

H90/HQ90 PERFORMANCE CHARACTERISTICS

| Body Size | H9012/HQ9012 | |
|------------------------------------|-------------------------------|-------------------------------|
| | Pressure in bar - Flow in LPM | Pressure in PSI - Flow in GPM |
| Maximum working pressure (Coupled) | 350 | 5075 |
| | Burst pressure (Coupled) | 1400 / 20300 |
| Burst pressure (Male) | 1300 | 18850 |
| | Burst pressure (Female) | 1000 / 14500 |
| Rated flow | 45 | 12 |

CAPS ACCESSORIES

| FEMALE CAPS | MALE CAPS |
|-------------|------------|
| HQ12-F-CAP | HQ12-M-CAP |

Standard colour is red pvc, other colours available upon request

H90/HQ90 Series

H90

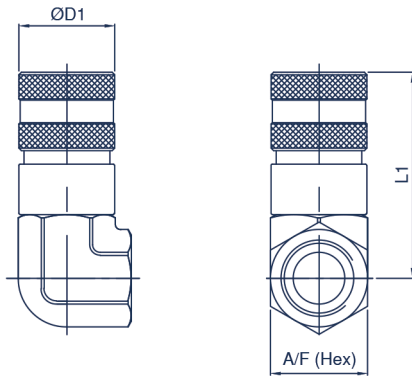

HQ90

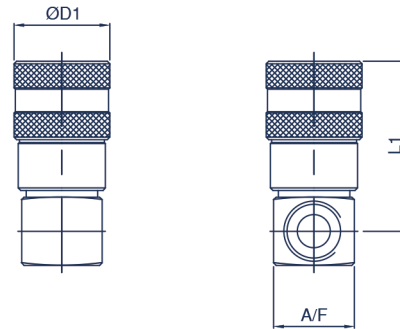

H90 FEMALE SERIES

| Body Size | Part Number | Thread Size | D1 | | L1 | | A/F | |
|-----------|---------------|--------------|------|------|------|------|------|------|
| | | | mm | inch | mm | inch | mm | inch |
| 12 (1/2) | H12-F-06JM-90 | 9/16-18 UNF | 38.0 | 1.50 | 81.7 | 3.22 | 34.0 | 1.34 |
| | H12-F-08S-90 | 3/4-16 UNF | 38.0 | 1.50 | 81.7 | 3.22 | 34.0 | 1.34 |
| | H12-F-12JM-90 | 1 1/16-12 UN | 38.0 | 1.50 | 81.7 | 3.22 | 34.0 | 1.34 |

HQ90 FEMALE SERIES

| Body Size | Part Number | Thread Size | D1 | | L1 | | A/F | |
|-----------|---------------|-------------|------|------|------|------|------|------|
| | | | mm | inch | mm | inch | mm | inch |
| 12 (1/2) | HQ12-F-04S-90 | 7/16-20 UNF | 38.0 | 1.50 | 64.3 | 2.53 | 32.0 | 1.26 |
| | HQ12-F-06-90 | 9/16-18 UNF | 38.0 | 1.50 | 64.3 | 2.53 | 32.0 | 1.26 |
| | HQ12-F-08N-90 | 1/2 NPTF | 38.0 | 1.50 | 70.8 | 2.79 | 32.0 | 1.26 |
| | HQ12-F-08S-90 | 3/4-16 UNF | 38.0 | 1.50 | 66.9 | 2.63 | 32.0 | 1.26 |

H90

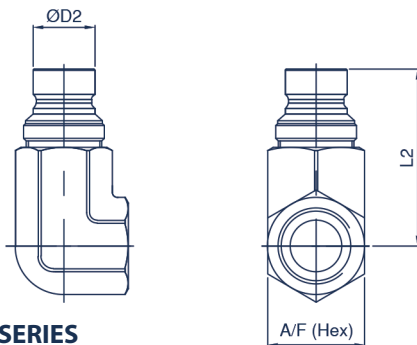

HQ90

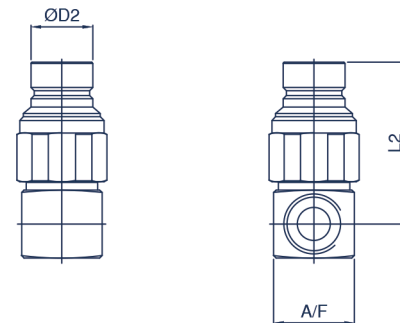

H90 MALE SERIES

| Body Size | Part Number | Thread Size | D2 | | L2 | | A/F | |
|-----------|---------------|--------------|------|------|------|------|------|------|
| | | | mm | inch | mm | inch | mm | inch |
| 12 (1/2) | H12-M-06JM-90 | 9/16-18 UNF | 24.5 | 0.97 | 68.2 | 2.69 | 34.0 | 1.34 |
| | H12-M-08S-90 | 3/4-16 UNF | 24.5 | 0.97 | 68.2 | 2.69 | 34.0 | 1.34 |
| | H12-M-12JM-90 | 1 1/16-12 UN | 24.5 | 0.97 | 68.2 | 2.69 | 34.0 | 1.34 |

HQ90 MALE SERIES

| Body Size | Part Number | Thread Size | D2 | | L2 | | A/F | |
|-----------|---------------|-------------|------|------|------|------|------|------|
| | | | mm | inch | mm | inch | mm | inch |
| 12 (1/2) | HQ12-M-04S-90 | 7/16-20 UNF | 24.5 | 0.97 | 61.0 | 2.40 | 32.0 | 1.26 |
| | HQ12-M-06-90 | 9/16-18 UNF | 24.5 | 0.97 | 61.0 | 2.40 | 32.0 | 1.26 |
| | HQ12-M-08N-90 | 1/2 NPTF | 24.5 | 0.97 | 67.9 | 2.67 | 32.0 | 1.26 |
| | HQ12-M-08S-90 | 3/4-16 UNF | 24.5 | 0.97 | 63.3 | 2.49 | 32.0 | 1.26 |

For all other configurations or thread types please contact the sales office.