



# Screw to connect semi flat face zero leakage couplings

## RK Series



### INTRODUCTION

Holmbury's RK Series screw to connect couplings are designed for heavy-duty service conditions in applications including construction plant, high pressure pulse and agricultural machinery.



### CONSTRUCTION

- Carbon steel with zinc nickel plating (1200 hours with no red rust in salt spray tests)
- Fitted with NBR seals

### FEATURES

- Screw to connect design eliminates brinelling
- Allows for minimal inclusion of air and contaminants during connection
- Flat face design prevents fluid loss during disconnection
- Bidirectional flow
- Can be connected with up to 50 bar (735 psi) residual pressure in the hydraulic circuit

### ACCESSORIES

- Dust caps, plugs and seal kits are available for the RK Series

### SPECIFICATIONS

- Operating temperatures (With NBR seals): -40°C (-40°F) to 106°C (223°F)

### APPLICATIONS

- High pressure pulse applications
- Construction plant
- Mobile equipment
- Demolition
- Agricultural

### RK PERFORMANCE CHARACTERISTICS

Body Size	RK08	RK12	RK16	RK20	RK25
	Pressure in bar - Flow in LPM				
	Pressure in PSI - Flow in GPM				
Maximum working pressure (Coupled)	420 6090	420 6090	420 6090	350 5075	420 6090
Burst pressure (Coupled)	1600 23205	1600 23206	1260 18275	1000 14505	1150 16680
Burst pressure (Male)	1600 23205	1600 23205	1260 18275	1000 14505	1100 15955
Burst pressure (Female)	1600 23205	1600 23205	1260 18275	1200 17405	900 13055
Rated flow	23 6.1	45 11.9	74 20	106 28	189 50

### CAPS/PLUGS ACCESSORIES

FEMALE CAPS	MALE PLUGS
RK08-F-CAP	RK08-M-PLUG
RK12-F-CAP	RK12-M-PLUG
RK16-F-CAP	RK16-M-PLUG
RK20-F-CAP	RK20-M-PLUG
RK25-F-CAP	RK25-M-PLUG

Standard material is natural, anodized aluminium

### SEAL KITS

FEMALE SEALS	MALE SEALS
RK08-F-SEAL KIT	RK08-M-SEAL KIT
RK12-F-SEAL KIT	RK12-M-SEAL KIT
RK16-F-SEAL KIT	RK16-M-SEAL KIT
RK20-F-SEAL KIT	RK20-M-SEAL KIT
RK25-F-SEAL KIT	RK25-M-SEAL KIT

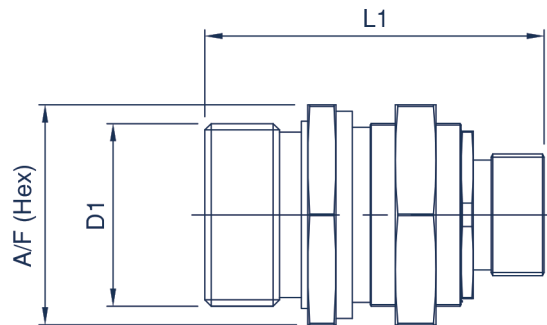

## RK FEMALE COUPLING

Body Size	Part Number	Thread Size	A/F		D1 (Thread)	L1	
			mm	inch		mm	inch
08 (5/16)	RK08-F-M14X1.5M-8L	M14X1.5	36.0	1.42	M32X3	57.0	2.24
	RK08-F-M16X1.5M-10L	M16X1.5	36.0	1.42	M32X3	58.0	2.28
	RK08-F-M18X1.5M-12L	M18X1.5	36.0	1.42	M32X3	58.0	2.28
	RK08-F-M22X1.5M-15L	M22X1.5	36.0	1.42	M32X3	59.0	2.32
	RK08-F-M18X1.5M-10S	M18X1.5	36.0	1.42	M32X3	59.0	2.32
	RK08-F-M20X1.5M-12S	M20X1.5	36.0	1.42	M32X3	59.0	2.32
	RK08-F-M22X1.5M-14S	M22X1.5	36.0	1.42	M32X3	61.0	2.40
	RK08-F-M24X1.5M-16S	M24X1.5	36.0	1.42	M32X3	61.0	2.40
12 (1/2)	RK12-F-M22MX1.5-15L	M22X1.5	41.0	1.61	M36X3	65.0	2.56
	RK12-F-M24X1.5M-16S	M24X1.5	41.0	1.61	M36X3	67.0	2.64
	RK12-F-M30X2M-20S	M30X2	41.0	1.61	M36X3	69.5	2.74
16 (5/8)	RK16-F-M22X1.5M-15L	M22X1.5	55.0	2.17	M48X3	75.2	2.96
	RK16-F-M26X1.5M-18L	M26X1.5	55.0	2.17	M48X3	75.2	2.96
	RK16-F-M24X1.5M-16S	M24X1.5	55.0	2.17	M48X3	77.2	3.04
	RK16-F-M30X2M-20S	M30X2	55.0	2.17	M48X3	79.2	3.12
20 (7/8)	RK20-F-M26X1.5M-18L	M26X1.5	55.0	2.17	M54X4	91.0	3.58
	RK20-F-M30X2M-22L	M30X2	55.0	2.17	M54X4	93.0	3.66
	RK20-F-M36X2M-28L	M36X2	55.0	2.17	M54X4	92.0	3.62
	RK20-F-M30X2M-20S	M30X2	55.0	2.17	M54X4	95.0	3.74
	RK20-F-M36X2M-25S	M36X2	55.0	2.17	M54X4	97.0	3.82
	RK20-F-M42X2M-30S	M42X2	55.0	2.17	M54X4	99.0	3.90
25 (1)	RK25-F-M45X2M-35L	M45X2	85.0	3.35	M79X4	122.0	4.80
	RK25-F-M52X2M-42L	M52X2	85.0	3.35	M79X4	119.0	4.80
	RK25-F-M52X2-38S	M52X2	85.0	3.35	M79X4	125.0	4.92

For all other configurations or thread types please contact the sales office.

**CAUTION** - Please see installation guide on page 89



## Screw to connect semi flat face zero leakage couplings

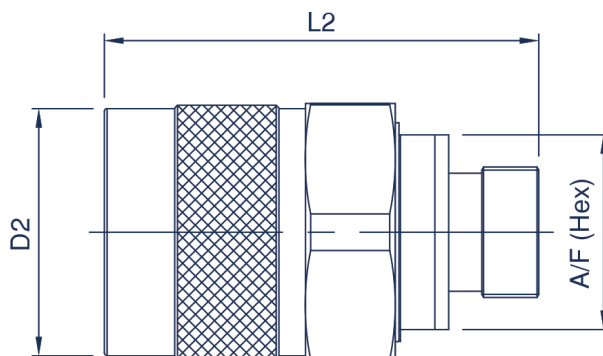

### RK MALE COUPLING

Body Size	Part Number	Thread Size	D2		L2		A/F	
			mm	inch	mm	inch	mm	inch
08 (5/16)	RK08-M-M14X1.5M-8L	M14X1.5	39.0	1.54	61.4	2.42	22.0	0.87
	RK08-M-M16X1.5M-10L	M16X1.5	39.0	1.54	62.4	2.46	22.0	0.87
	RK08-M-M18X1.5M-12L	M18X1.5	39.0	1.54	62.4	2.46	22.0	0.87
	RK08-M-M22X1.5M-15L	M22X1.5	39.0	1.54	63.4	2.50	22.0	0.87
	RK08-M-M18X1.5M-10S	M18X1.5	39.0	1.54	63.4	2.50	22.0	0.87
	RK08-M-M20X1.5M-12S	M20X1.5	39.0	1.54	63.4	2.50	22.0	0.87
	RK08-M-M22X1.5M-14S	M22X1.5	39.0	1.54	65.4	2.57	36.0	1.42
	RK08-M-M24X1.5M-16S	M24X1.5	39.0	1.54	65.4	2.57	36.0	1.42
12 (1/2)	RK12-M-M22MX1.5-15L	M22X1.5	45.0	1.77	78.0	3.07	36.0	1.42
	RK12-M-M24X1.5M-16S	M24X1.5	45.0	1.77	80.0	3.15	36.0	1.42
	RK12-M-M30X2M-20S	M30X2	45.0	1.77	95.0	3.20	36.0	1.42
16 (5/8)	RK16-M-M22X1.5M-15L	M22X1.5	59.0	2.32	79.0	3.11	32.0	1.26
	RK16-M-M26X1.5M-18L	M26X1.5	59.0	2.32	79.0	3.11	32.0	1.26
	RK16-M-M24X1.5M-16S	M24X1.5	59.0	2.32	81.0	3.19	32.0	1.26
	RK16-M-M30X2M-20S	M30X2	59.0	2.32	83.0	3.19	32.0	1.26
20 (7/8)	RK20-M-M26X1.5M-18L	M26X1.5	64.0	2.52	103.0	4.06	41.0	1.61
	RK20-M-M30X2M-22L	M30X2	64.0	2.52	105.0	4.13	41.0	1.61
	RK20-M-M36X2M-28L	M36X2	64.0	2.52	107.0	4.21	41.0	1.61
	RK20-M-M30X2M-20S	M30X2	64.0	2.52	109.0	4.29	41.0	1.61
	RK20-M-M36X2M-25S	M36X2	64.0	2.52	111.0	4.37	41.0	1.61
	RK20-M-M42X2M-30S	M42X2	64.0	2.52	111.0	4.37	41.0	1.61
25 (1)	RK25-M-M45X2M-35L	M45X2	90.0	3.54	136.0	5.35	55.0	2.17
	RK25-M-M52X2M-42L	M52X2	90.0	3.54	136.0	5.35	55.0	2.17
	RK25-M-M52x2M-38S	M52X2	90.0	3.54	136.0	5.35	55.0	2.17

For all other configurations or thread types please contact the sales office.