



# Trailer brake couplings made to the ISO 5676 Standard

## TB Series



### INTRODUCTION

Holmbury's TB Series trailer brake couplings are used to connect the hydraulic braking system of tractors to trailers. The male coupling is normally panel mounted on the tractor.

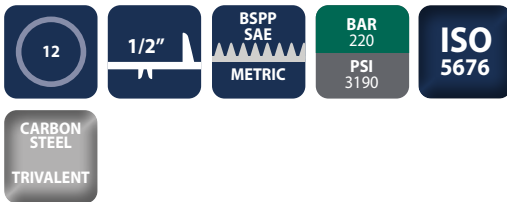

### CONSTRUCTION

- Carbon steel with trivalent plating
- Fitted with Nitrile seals

### FEATURES

- Male couplings can be panel mounted
- Female couplings are supplied with parking station
- Bidirectional flow

### ACCESSORIES

- Not applicable

### SPECIFICATIONS

- Operating temperatures (with Nitrile seals): -40°C (-40°F) to 106°C (223°F)

### APPLICATIONS

- Trailer connections
- Hydraulic brake systems

### TB PERFORMANCE CHARACTERISTICS

Series Variant	TB12
	Pressure in bar - Flow in LPM
	Pressure in PSI - Flow in GPM
Maximum working pressure (Coupled)	220
	3190
Burst pressure (Coupled)	900
	13050
Burst pressure (Male)	1110
	16095
Burst pressure (Female)	900
	13050
Rated flow	45
	12

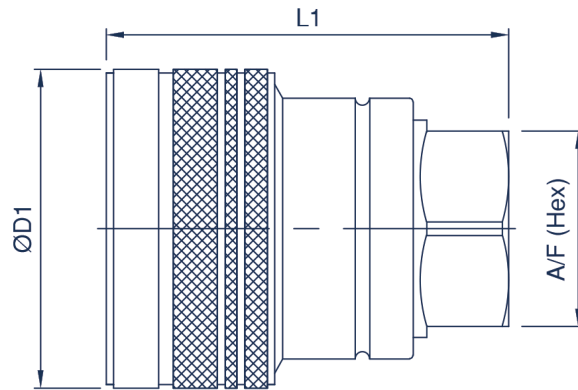

## TB FEMALE COUPLING

Body Size	Part Number	Thread Size	D1		L1		A/F	
			mm	inch	mm	inch	mm	inch
12 (1/2)	TB12-F-06G	3/8 BSPP	44.0	1.73	55.5	2.19	27.0	1.06
	TB12-F-08G	1/2 BSPP	44.0	1.73	55.5	2.19	27.0	1.06
	TB12-F-M16x1.5	M16x1.5	44.0	1.73	55.5	2.19	27.0	1.06
	TB12-F-M20x1.5	M20x1.5	44.0	1.73	55.5	2.19	27.0	1.06
	TB12-F-M22X1.5M-BH-15L	M22X1.5	44.0	1.73	58.5	2.30	27.0	1.06

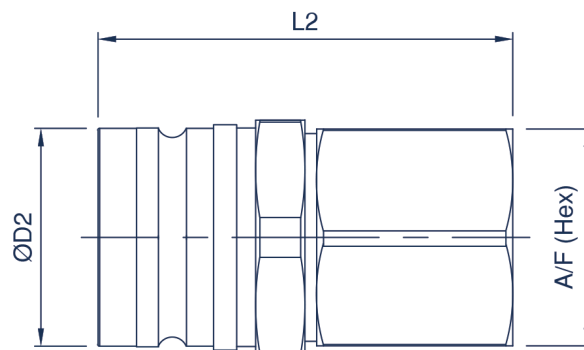

## TB MALE COUPLING

Body Size	Part Number	Thread Size	D2		L2		A/F	
			mm	inch	mm	inch	mm	inch
12 (1/2)	TB12-M-06G	3/8 BSPP	29.0	0.81	55.5	2.19	30.0	1.18
	TB12-M-08G	1/2 BSPP	29.0	0.81	55.5	2.19	30.0	1.18
	TB12-M-08GM	1/2 BSPP	29.0	0.81	48.0	1.89	30.0	1.18
	TB12-M-08GM-BHX36	1/2 BSPP	29.0	0.81	58.5	2.30	30.0	1.18
	TB12-M-08SM	3/4-16 UNF	29.0	0.81	48.0	1.89	30.0	1.18
	TB12-M-M18x1.5M-BH-12L	M18X1.5	29.0	0.81	58.5	2.30	30.0	1.18
	TB12-M-M20x1.5M-BH-12S	M20x1.5	29.0	0.81	58.5	2.30	30.0	1.18
	TB12-M-M22x1.5M-BH-15L	M22X1.5	29.0	0.81	58.5	2.30	30.0	1.18

For all other configurations or thread types please contact the sales office.