



Flat face couplings



SFF Series



INTRODUCTION

The SFF Series flat face couplings are Industrial Dry Break Couplings with excellent flow and flow characteristics.



CONSTRUCTION

- Carbon steel with zinc nickel plating (1200 hours with no red rust in salt spray tests)
- Fitted with NBR & PTFE seals
- Also available in Chrome III finish

FEATURES

- Safety locking sleeve fitted as standard to prevent accidental disconnection
- Bidirectional flow
- Flush face design allows faces to be wiped clean to prevent ingress of dirt and contaminants

SPECIFICATIONS

- -30 C (-22 F) to 120 C (250 F)
- Couplings have been tested to the ISO 18869 Standard

APPLICATIONS

- Hydraulic hand tools
- Mobile equipment
- Industrial hydraulics

SFF PERFORMANCE CHARACTERISTICS

Body Size	SFF10
	Pressure in bar - Flow in LPM Pressure in PSI - Flow in GPM
Maximum working pressure (Coupled)	210
	3045
Burst pressure (Coupled)	1420
	20,600
Burst pressure (Male)	1105
	16,025
Burst pressure (Female)	835
	12,110
Rated flow	23
	6.1

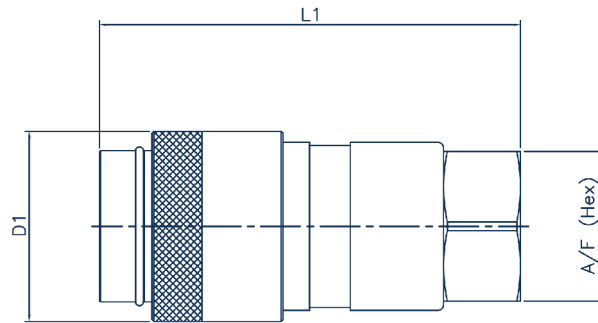

SFF FEMALE COUPLING

Body Size	Part Number	Thread Size	D1		L1		A/F	
			mm	inch	mm	inch	mm	inch
10 (3/8)	SFF10-F-06N	3/8 NPTF	30.5	1.20	67.5	2.65	24.0	0.95

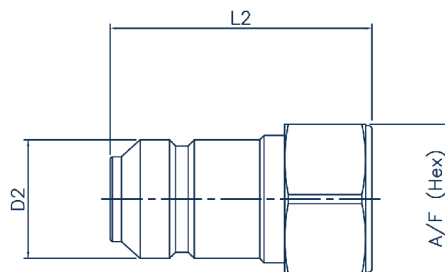

SFF MALE COUPLING

Body Size	Part Number	Thread Size	D2		L2		A/F	
			mm	inch	mm	inch	mm	inch
10 (3/8)	SFF10-M-06N	3/8 NPTF	19.0	0.75	42.0	1.65	24.0	0.95